

CAMC0309637



INYO, County Recorder
KAMMI FOOTE Co Recorder Office
DOC- 2015-0002119-00
Check Number 10901

Wednesday, AUG 12, 2015 10:05:53
MIC \$1.00:S21 \$3.00:REC \$14.00
SYS \$4.00:SST \$1.00:

Ttl Pd \$23.00 Rcpt # 0000110655
LS1/R1/1-4

RECORDING REQUESTED BY:
(Mail recording to:)

Name

ACE Cogeneration Company

Address

P.O. Box 66

Trona, CA 93592

FOR RECORDER'S USE

PLACER MINING CLAIM LOCATION NOTICE (CALIFORNIA)

To whom it may concern, please take notice that:

- Placer mining claim name is Limestone # 16
- Date of location (date the proper location monument was erected and location notice posted in or on it) of this placer mining claim is 9 25 2014
(month) (day) (year)
- Description of the discovery monument is as follows: See attachments

4. Placer mining claim IS IN an area where there is a U.S. Public Land Survey and the description of the claim by legal subdivision including aliquot part (A.P.) of section (such as E1/2NE1/4NE1/4), Section (Sec.), Township (T.), Range (R.) and Meridian (Mer.), is as follows:

A.P. NE 1/4 NW 1/4 NE 1/4 ⁴⁰⁴⁴ Sec. 13, T. 21S, R. 42E, Mer. MDM

A.P. N 1/2 NW 1/4 NE 1/4, Sec. _____, T. _____, R. _____, Mer. _____

A.P. _____, Sec. _____, T. _____, R. _____, Mer. _____

A.P. _____, Sec. _____, T. _____, R. _____, Mer. _____

5. Placer mining claim IS NOT IN an area where there is a U.S. Public Land Survey, is marked by conspicuous and substantial monument at each claim corner, and is located by properly marked boundaries described below in reference to some natural object:

Natural object is (description) _____, and it is by compass direction _____, about _____ feet to the discovery monument. From the discovery monument it is by compass direction _____, about _____ feet to the NW corner post; from here it is by compass direction _____, about _____ feet to the NE corner post; from here it is by compass direction _____, about _____ feet to the SE corner post; from here it is by compass direction _____, about _____ feet to the SW corner post; from here it is by compass direction _____, about _____ feet to the NW corner post.

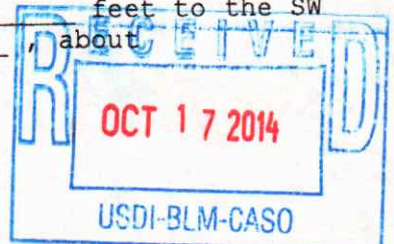

6A. The undersigned locator(s) have defined the boundaries of the claim by erecting at each corner of the claim, or nearest accessible points thereto, a proper monument and each corner monument so erected bears or contains markings sufficient to appropriately designate the corner of the claim and the name of the claim.

6B. The date of monument erection and marking is 9 25 2014
(month) (day) (year)

6C. Description of each monument is as follow See attachments

7. Attach to this Notice an appropriate U.S. Geologic Survey topographic map showing a sketch of the outline of the placer mining claim.

8. Placer mining claim is in Inyo County.

9. Placer mining claim contain(s) 20 acres.

10. If your placer mining claim is in a power site withdrawal as determined from BLM Master Title Plat records, write "Filed under P.L. 359" on this line

11. Locator(s) of this placer claim are: (Please Print)

| Name(s) | Current Mailing or Residence Address |
|--------------------------|--------------------------------------|
| ACE Cogeneration Company | P.O. Box 66 Trona, CA 93592 |
| | |
| | |
| | |
| | |
| | |
| | |
| | |

12. Signatures of locator(s):

David Solomon Date 10/15/14
as agent for:

ACE Cogeneration Company Date _____

Date _____

Date _____



LOCATION NOTICE
PLACER

RECEIVED
BUREAU OF LAND MANAGEMENT

Attached
04 03 00 23100
20012412

NOTICE IS HEREBY GIVEN: That the undersigned has this 15th day of April 1955, located a placer mining claim situated in unknown Inyo Mining District, County of San Bernardino, State of California, described as follows:

(a) IF UNSURVEYED LAND, GIVE DETAILED DESCRIPTION:

(b) OR, IF SURVEYED LAND, GIVE LEGAL SUBDIVISIONS:

The N.E. 1/4 of the N.W. 1/4 of the N.E. 1/4 and the N.W. 1/4 of the N.E. 1/4 of the N.E. 1/4 of the N.E. 1/4

of Section 13, Township 21.S., Range 42.E., Meridian M.D.M.

together with all water and timber appurtenant, allowed by law.

THIS CLAIM, consisting of 20 acres, shall be known as LIMESTONE #16 Mining Claim.

THIS CLAIM may be identified by its proximity to the following natural object or permanent monument, to-wit: Located by legal subdivision

LOCATORS'

H. D. Hellmers
H. D. Hellmers



STATEMENT OF THE MARKING OF THE BOUNDARIES AND OF PERFORMANCE OF DISCOVERY WORK

NOTICE IS HEREBY GIVEN by the undersigned locator—that in accordance with the provisions of the Mining Law:—

1. (If unsurveyed Land) There has been erected at the discovery point, and at each corner of said claim, Located by legal subdivision (Posts or Markings)

2. The Locator has performed, within 90 days from date of location, the following discovery work: Excavated an open cut upon the claim and removed from the cut more than 7 cubic yards of material.

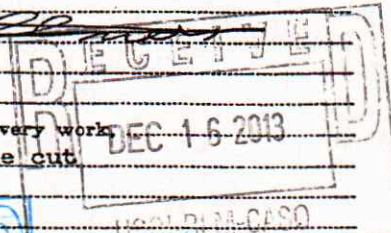

LOCATORS:
H. D. Hellmers

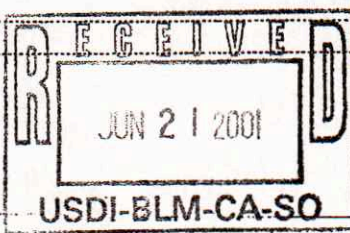

NO. 454
RECORDED AT THE REQUEST OF
H. D. Hellmers
21 MINUTES PAST 9 O'CLOCK A.M.
MAY 16 1955
VOL 75 OF Mining Locations
PAGE 40
RECORD OF INTO FOREST CASE
BY RICHARD F. CRYST, Recording
BY *Richard F. Cryst*

Exhibit A

20150002119

A Hochstet
CAMC 23068

20012412

CAMC0308090 26

CAMC0309637 25

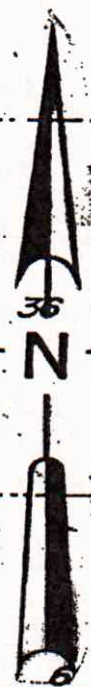
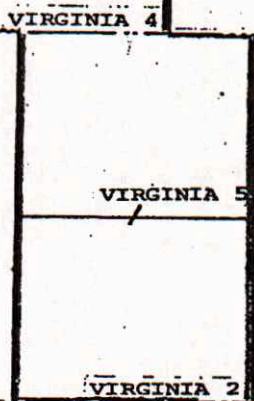
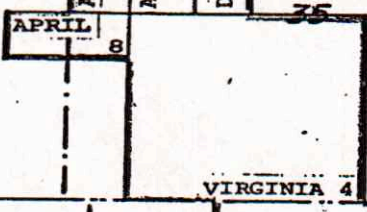
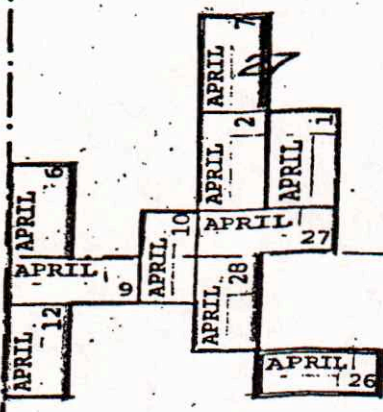

T20S
T21S

SCALE: 1 in = 2000 ft

RECEIVED
OCT 17 2014
USDI-BLM-CASO

RECEIVED
JUN 21 2001
USDI-BLM-CA-SO

LIME STONE 19
LIME STONE 18
LIME STONE 17
LIME STONE 16
LIME STONE 15
LIME STONE 14
LIME STONE 13
LIME STONE 12
LIME STONE 11
LIME STONE 10
LIME STONE 9
LIME STONE 8
LIME STONE 7
LIME STONE 6
LIME STONE 5
LIME STONE 4
LIME STONE 3
LIME STONE 2
LIME STONE 1

RECEIVED
DEC 16 2013
USDI-BLM-CASO

~~APRIL ET AL GROUPS~~
~~KERR-MCGEE CHEMICAL CORPORATION~~
SEC'S. 26, 27, 34 & 35 of Twp. 20 S.,
Rge. 42 E., SEC'S. 1 & 12 of Twp. 21 S.
Rge. 42 E., SEC'S. 7 & 18 of
Twp. 21 S., Rge. 43 E., M.D.M.
INYO COUNTY, CALIFORNIA

RECEIVED
OCT - 9 2014
USDI-BLM-CASO

Exhibit B

R42E
R43E