

AMC0309601



RECORDING REQUESTED BY:
(Mail recording to:)

INYO, County Recorder
KAMMI FOOTE Co Recorder Office
DOC- 2015-0002083-00
Check Number 10901
Wednesday, AUG 12, 2015 09:48:15
MIC \$1.00:S21 \$4.00:REC \$15.00
SYS \$5.00:SST \$1.00:
Ttl Pd \$26.00 Rcpt # 0000110583
LS1/R1/1-5

Name
ACE Cogeneration Company

Address
P.O. Box 62
Trona, Ca. 93592

FOR RECORDER'S USE

PLACER MINING CLAIM LOCATION NOTICE (CALIFORNIA)

To whom it may concern, please take notice that:

- 1. Placer mining claim name is Virginia
- 2. Date of location (date the proper location monument was erected and location notice posted in or on it) of this placer mining claim is 9 25 2014
(month) (day) (year)
- 3. Description of the discovery monument is as follows: See Attachments

4. Placer mining claim IS IN an area where there is a U.S. Public Land Survey and the description of the claim by legal subdivision including aliquot part (A.P.) of section (such as E1/2NE1/4NE1/4), Section (Sec.), Township (T.), Range (R.) and Meridian (Mer.), is as follows:

A.P. E 1/2 SE 1/4 , Sec. 7, 12 , T. 21S , R. 43E, 42E , Mer. MDM
 A.P. W 1/2 SW 1/4 , Sec. _____ , T. _____ , R. _____ , Mer. _____
 A.P. _____ , Sec. _____ , T. _____ , R. _____ , Mer. _____
 A.P. _____ , Sec. _____ , T. _____ , R. _____ , Mer. _____

5. Placer mining claim IS NOT IN an area where there is a U.S. Public Land Survey, is marked by conspicuous and substantial monument at each claim corner, and is located by properly marked boundaries described below in reference to some natural object:

Natural object is (description) _____ , and it is by compass direction _____ , about _____ feet to the discovery monument. From the discovery monument it is by compass direction _____ , about _____ feet to the NW corner post; from here it is by compass direction _____ , about _____ feet to the NE corner post; from here it is by compass direction _____ , about _____ feet to the SE corner post; from here it is by compass direction _____ , about _____ feet to the SW corner post; from here it is by compass direction _____ , about _____ feet to the NW corner post.



CAMC0309601

6A. The undersigned locator(s) have defined the boundaries of the claim by erecting at each corner of the claim, or nearest accessible points thereto, a proper monument and each corner monument so erected bears or contains markings sufficient to appropriately designate the corner of the claim and the name of the claim.

6B. The date of monument erection and marking is 9 25 2014.
(month) (day) (year)

6C. Description of each monument is as follow See Attachments

7. Attach to this Notice an appropriate U.S. Geologic Survey topographic map showing a sketch of the outline of the placer mining claim.

8. Placer mining claim is in INYO County.

9. Placer mining claim contain(s) 160 acres.

10. If your placer mining claim is in a power site withdrawal as determined from BLM Master Title Plat records, write "Filed under P.L. 359" on this line

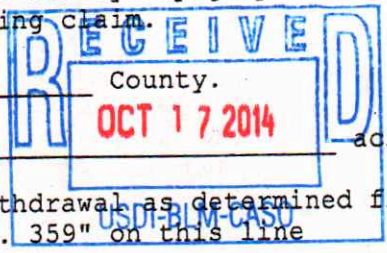

11. Locator(s) of this placer claim are: (Please Print)

<u>Name(s)</u>	<u>Current Mailing or Residence Address</u>
<u>Steven Halerman</u>	<u>P.O. Box 66 Trona, CA 93592</u>
<u>Annette Taylor</u>	<u>P.O. Box 66 Trona, CA 93592</u>
<u>JON D. GRAVES</u>	<u>P.O. Box 66 TRONA, CA 93592</u>
<u>Susan Hartson</u>	<u>P.O. Box 66 Trona CA 93592</u>
<u>Jim Cox</u>	<u>P.O. Box 66 Trona CA 93592</u>
<u>Steve Miller</u>	<u>PO Box 66 Trona Ca 93592</u>
<u>Richard Pointz</u>	<u>P.O. Box 66 TRONA CA 93592</u>
<u>TROY SEBLEY</u>	<u>P.O. Box 66 TRONA CA 93592</u>

12. Signatures of locator(s):

<u>[Signature]</u>	Date <u>10/15/14</u>	<u>[Signature]</u>	Date <u>10-15-14</u>
<u>[Signature]</u>	Date <u>10/15/14</u>	<u>[Signature]</u>	Date <u>10/15/14</u>
<u>[Signature]</u>	Date <u>10/15/14</u>	<u>Richard Pointz</u>	Date <u>10/15/14</u>
<u>[Signature]</u>	Date <u>10-15-14</u>	<u>[Signature]</u>	Date <u>10/15/14</u>

CAMCO 23089

~~VOL 72 PAGE 608~~ Notice of Location

~~Placer Claim~~

CAMCO309601

(See Sections 2301 - 2324, Inclusive, Public Resources Code)

RECEIVED
BUR. OF LAND MGMT.
MAR 16 10 00 AM '79

SACRAMENTO, CALIFORNIA

TO WHOM IT MAY CONCERN: Please take notice that:

20012440

- (1) The name of this claim is VIRGINIA
- (2) The name ~~S~~ of the locators ~~s~~ of said claim are:

H. D. Hellmers	(is - are)	<u>Virginia Wiseman</u>
<u>James V. Wiseman</u>		Christine M. Hellmers
Charles E. Ousley		<u>Lynn A. Blackmun</u>
Kenneth B. Ousley		Margaret Ousley

Said locators ~~are~~ citizen of the United States of America or ~~has~~ declared ~~his~~ intention ~~to become such~~ ~~(is - are)~~ ~~(has - have)~~ ~~(his - their)~~

(3) The said locator ~~s~~ do hereby claim and locate a placer mining claim situate on public surveyed land in the Argus Mining District, County of Inyo, State of California, described as follows:

(a) The East 1/2 of the S.E. 1/4 of Section 12, in Township 21.S., Range 42.E. and the West 1/2 of the S.W. 1/4 of Sec. 7, T.21.S., R.43.E. containing 160 acres.

(b) Beginning at this stone monument (tree, rock in place, stone, post or monument)

upon which is posted the notice of location, thence

(direction)	<u>Easterly</u>	<u>1320</u>	feet to a post marked	<u>N.E. Corner</u>	thence
(direction)	<u>Southerly</u>	<u>2640</u>	feet to a post marked	<u>S.E. Corner</u>	thence
(direction)	<u>Westerly</u>	<u>2640</u>	feet to a post marked	<u>S.W. Corner</u>	thence
(direction)	<u>Northerly</u>	<u>2640</u>	feet to a post marked	<u>N.W. Corner</u>	thence
(direction)	<u>Easterly</u>	<u>1320</u>	feet to place of beginning.	Said placer mining claim contains <u>160</u> acres.	

All of said posts are at least four inches in diameter, are set at least one foot in the ground and are surrounded by a mound of stone.

This location is situated about _____ feet distant from _____

(name some natural object or permanent monument)

(4) The date of this location is the 29th day of March, 1955

(5) This notice is intended as an original notice of location and is posted on this claim and a true copy thereof is to be recorded with the County Recorder of this County.

DATED: _____, 19____
WITNESSES: _____

LOCATORS:

James V. Wiseman
Virginia Wiseman
Lynn A. Blackmun
Margaret Ousley

RECEIVED
OCT 17 2014
USDI-BLM-CASO

RECEIVED
JUN 26 2001
USDI-BLM-CASO

Footnote 1, 2, 3, 4, 5, 6, 7, 8, 9, 10, 11, 12, 13, 14, 15, 16, 17, 18, 19, 20, 21, 22, 23, 24, 25, 26, 27, 28, 29, 30, 31, 32, 33, 34, 35, 36, 37, 38, 39, 40, 41, 42, 43, 44, 45, 46, 47, 48, 49, 50, 51, 52, 53, 54, 55, 56, 57, 58, 59, 60, 61, 62, 63, 64, 65, 66, 67, 68, 69, 70, 71, 72, 73, 74, 75, 76, 77, 78, 79, 80, 81, 82, 83, 84, 85, 86, 87, 88, 89, 90, 91, 92, 93, 94, 95, 96, 97, 98, 99, 100

Exhibit A USDI-BLM-CASO

CAMC 23089

75 PAGE 405

RECEIVED
BUR. OF LAND RIGHT.

20012440

CAMCO30960 MAR 16 10 00 AM '79

CAMCO278793

SACRAMENTO, CALIFORNIA

~~NOTICE OF AMENDED LOCATION OF~~
VIRGINIA PLACER MINING CLAIM

~~KNOW ALL MEN BY THESE PRESENTS THAT DOROTHY OUSLEY, ALENE BLACKMUN, JAMES V. WISEMAN, CHARLES E. OUSLEY, KENNETH B. OUSLEY, VIRGINIA WISEMAN, LYNN A. BLACKMUN and MARGARET OUSLEY, the undersigned citizens of the United States over the age of 21 years, have this 29th day of May, 1955, amended, located and claimed, and by these presents do amend, locate and claim by right of discovery and amended location, in compliance with the mining acts and laws of Congress and the local customs and laws and the laws of the State of California, 160 acres of placer mining ground, said discovery being within the lines of said claim and in an unknown mining district which may be called the Argus Mining District, in the County of Inyo, State of California, and which said claim is described as follows:~~

VIRGINIA, being a placer mining claim, located and situated on public surveyed land and described as the East half of the Southeast quarter of Section 12, in Township 21 South, Range 42 East, M.D.M., and the West half of the Southwest quarter of Section 7, Township 21 South, Range 43 East, M.D.M., containing 160 acres.

This being the same placer mining claim originally located on the 29th day of March, 1955, the Notice of Location of which was recorded March 31, 1955, in Book 72 of Mining Locations, at pages 608 and 609, records of Inyo County. It is known as VIRGINIA and is owned by the undersigned and above-named owners.

~~This further and amended notice of location is made without waiver of any previously acquired rights and is for the purpose of correcting errors in the description of the legal subdivisions contained in the original Notice of Location and correcting an error in the description of the position of the discovery monument in the original Notice of Location, and more definitely describing the situation and boundaries of said claim by proper reference to legal subdivisions, and supplying omissions and correcting any defects which may have existed in the original Notice of Location, and to appropriate all ground within the boundaries hereinbefore described. The position of the discovery monument is erroneously described in Paragraph (3)(b) of the original Notice as being on the south line of the claim. Said monument was substantially constructed of rock and stone and was more than 18 inches in height and was erected on the date of the location of the claim well within the boundaries of the claim. Said monument has always been situated at this position and not at the position described in the original Notice of Location. The error in the original Notice resulted from an ineffective attempt to conform to the partially printed material in the original printed Notice.~~

~~This Notice is intended as an Amended Notice of Location and is posted on the claim this date, and a true copy is to be recorded with the recorder of said County.~~

RECEIVED
OCT 17 2014
USDI-BLM-CASO

RECEIVED
CANCELED
4 2014
-1-
USDI-BLM-CASO

RECEIVED
JUN 26 2014
USDI-BLM-CA-SO

~~CAMC 23068~~

20012440

CAMC 0309601

CAMC 0278793

25

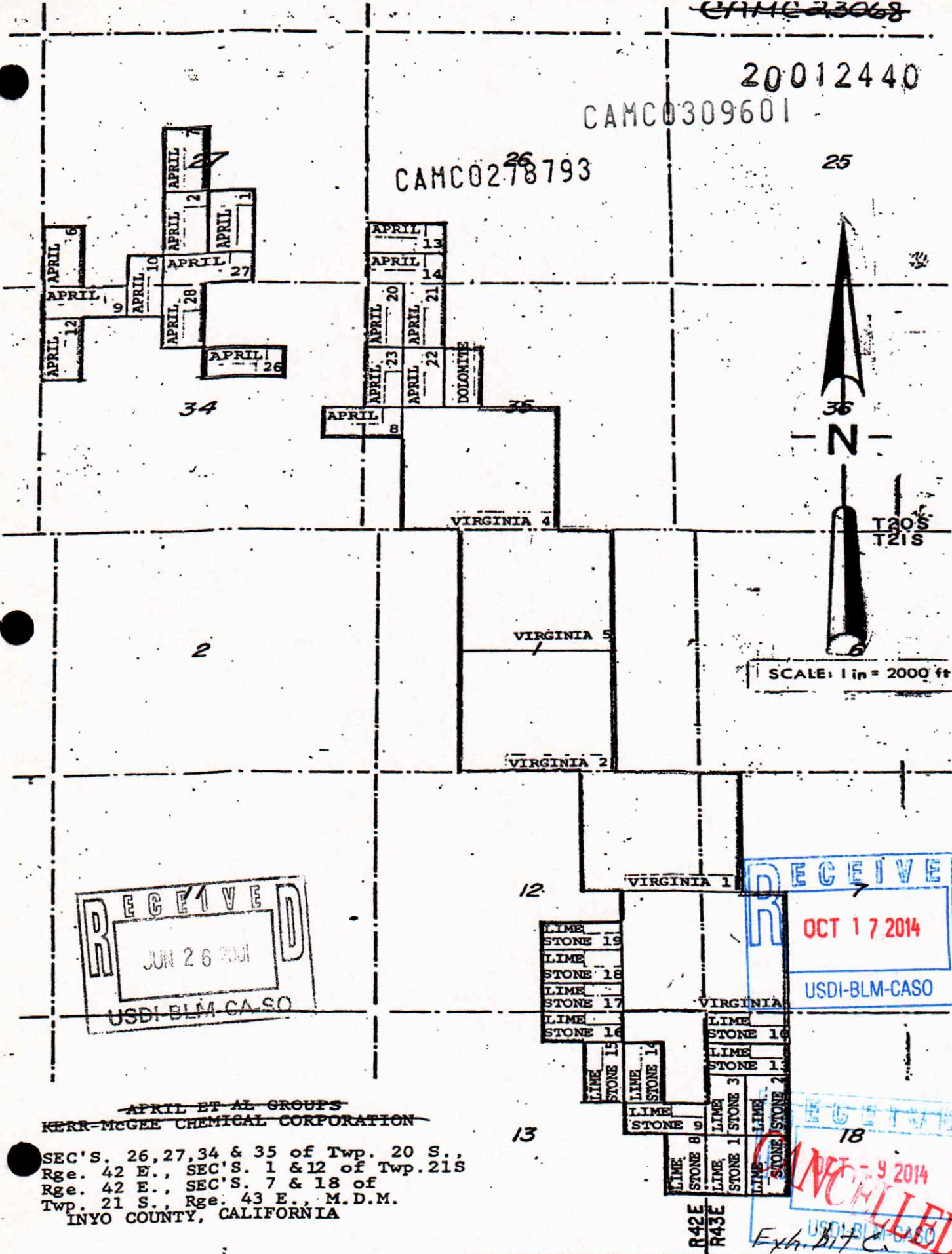

SCALE: 1 in = 2000 ft

RECEIVED
 JUN 26 2001
 USDI BLM CA-SO

RECEIVED
 OCT 17 2014
 USDI-BLM-CASO

RECEIVED
 OCT - 9 2014
 USDI BLM CASO
 Exhibit C

~~APRIL ET AL GROUPS~~
~~KERR-MCGEE CHEMICAL CORPORATION~~

SEC'S. 26, 27, 34 & 35 of Twp. 20 S.,
Rge. 42 E., SEC'S. 1 & 12 of Twp. 21 S.,
Rge. 42 E., SEC'S. 7 & 18 of
Twp. 21 S., Rge. 43 E., M.D.M.
INYO COUNTY, CALIFORNIA

R42E
R43E