

CAMCO309622



RECORDING REQUESTED BY:  
(Mail recording to:)

Name

ACE Cogeneration Company

Address

P.O. Box 66

Trona, CA 93592



INYO, County Recorder  
KAMMI FOOTE Co Recorder Office  
DOC- 2015-0002104-00

Check Number 10901

Wednesday, AUG 12, 2015 09:59:06

MIC \$1.00:S21 \$4.00:REC \$15.00

SYS \$5.00:SST \$1.00:

Ttl Pd \$26.00

Rept # 0000110625

LS1/R1/1-5

FOR RECORDER'S USE

PLACER MINING CLAIM LOCATION NOTICE (CALIFORNIA)

To whom it may concern, please take notice that:

- 1. Placer mining claim name is April # 22
- 2. Date of location (date the proper location monument was erected and location notice posted in or on it) of this placer mining claim is 9 25 2014  
(month) (day) (year)
- 3. Description of the discovery monument is as follows: See attachments

4. Placer mining claim IS IN an area where there is a U.S. Public Land Survey and the description of the claim by legal subdivision including aliquot part (A.P.) of section (such as E1/2NE1/4NE1/4), Section (Sec.), Township (T.), Range (R.) and Meridian (Mer.), is as follows:

A.P. E1/2SW1/4NW1/4, Sec. 35, T. 20S, R. 42E, Mer. MDM  
 A.P. \_\_\_\_\_, Sec. \_\_\_\_\_, T. \_\_\_\_\_, R. \_\_\_\_\_, Mer. \_\_\_\_\_  
 A.P. \_\_\_\_\_, Sec. \_\_\_\_\_, T. \_\_\_\_\_, R. \_\_\_\_\_, Mer. \_\_\_\_\_  
 A.P. \_\_\_\_\_, Sec. \_\_\_\_\_, T. \_\_\_\_\_, R. \_\_\_\_\_, Mer. \_\_\_\_\_

5. Placer mining claim IS NOT IN an area where there is a U.S. Public Land Survey, is marked by conspicuous and substantial monument at each claim corner, and is located by properly marked boundaries described below in reference to some natural object:

Natural object is (description) \_\_\_\_\_, and it is by compass direction \_\_\_\_\_, about \_\_\_\_\_ feet to the discovery monument. From the discovery monument it is by compass direction \_\_\_\_\_, about \_\_\_\_\_ feet to the NW corner post; from here it is by compass direction \_\_\_\_\_, about \_\_\_\_\_ feet to the NE corner post; from here it is by compass direction \_\_\_\_\_, about \_\_\_\_\_ feet to the SE corner post; from here it is by compass direction \_\_\_\_\_, about \_\_\_\_\_ feet to the SW corner post; from here it is by compass direction \_\_\_\_\_, about \_\_\_\_\_ feet to the NW corner post.





CAMC0309622

20150002104

6A. The undersigned locator(s) have defined the boundaries of the claim by erecting at each corner of the claim, or nearest accessible points thereto, a proper monument and each corner monument so erected bears or contains markings sufficient to appropriately designate the corner of the claim and the name of the claim.

6B. The date of monument erection and marking is 9 25 2014.  
(month) (day) (year)

6C. Description of each monument is as follow See attachments

7. Attach to this Notice an appropriate U.S. Geologic Survey topographic map showing a sketch of the outline of the placer mining claim.

8. Placer mining claim is in Inyo County.

9. Placer mining claim contain(s) 20 acres.

10. If your placer mining claim is in a power site withdrawal as determined from BLM Master Title Plat records, write "Filed under P.L. 359" on this line

11. Locator(s) of this placer claim are: (Please Print)

Name(s)	Current Mailing or Residence Address
ACE Cogeneration Company	P.O. Box 66 Trona, CA 93592

12. Signatures of locator(s):

[Signature] Date 10/15/14  
 as agent for:  
ACE Cogeneration Company Date \_\_\_\_\_  
 \_\_\_\_\_ Date \_\_\_\_\_  
 \_\_\_\_\_ Date \_\_\_\_\_





RECEIVED  
OCT 17 2014

NOTICE OF AMENDED LOCATION

2001-2420

KNOW ALL MEN BY THESE PRESENTS:

That STAUFFER CHEMICAL COMPANY is a corporation organized and existing under and by virtue of the laws of the State of Delaware and authorized to do and engage in business and to own property in the State of California, and that it has, on the date given below immediately above its execution of this document, amended, located and claimed, and by these presents does amend, locate and claim by right of discovery and location and this amended notice of location, in compliance with the mining laws of Congress and of the State of California and the local customs and laws of the district in which the claim is located, APRIL #14 MINING CLAIM, a placer mining claim.

The claim is situated in an unknown mining district in the County of Inyo, State of California. It was originally located by James V. Wiseman and Virginia Wiseman and the original location notice was recorded November 15, 1955 in Book 80 of Mining Locations, at page 132, in the office of the Recorder of said Inyo County.

The said locators, on the date given in the original notice of location, did locate and claim the said placer claim and the same was subsequently amended by posting and filing an amended notice of location. The undersigned corporation, being the present owner and proprietor of the said claim as amended, executes, posts and files this amended notice for the purpose of further amending the said claim to revise the description thereof and eliminate a portion of the area heretofore included in the claim.

The description of the area and premises included in the claim is hereby revised and amended, effective this date, to be and it is described as follows:

Beginning at the West quarter corner of Section 26, Township 20 South, Range 42 East, Mt. Diablo Meridian, in the County of Inyo, State of California; thence South 0° 27' 00" East 1983.7 feet to a point of beginning, being Corner No. 2 of April #14 Mining Claim, as per Mineral Survey No. 6589, California, approved January 6, 1958; thence South 0° 27' 00" East 661.3 feet to Corner No. 1 of April #14 Mining Claim, as shown on Mineral Survey No. 6589, California; thence North 89° 39' 20" East 1317.1 feet to Corner No. 4 of said April #14 Mining Claim, as shown on said Mineral Survey No. 6589, California; thence North 0° 25' 30" East 660.9 feet to Corner No. 3 of said April #14 Mining Claim, as shown on said Mineral Survey No. 6589, California; thence South 89° 35' 30" West 327.4 feet to a point on the East line of April Millsite, Mineral Survey No. 6685, California; thence South 0° 32' 00" East 208.0 feet to Corner No. 3 of said April Millsite, Mineral Survey No. 6685, California; thence South 0° 32' 00" East 330 feet to a point; thence South 89° 36' 50" West 660 feet to a point; thence North 0° 32' 00" West 330 feet to a point and Corner No. 4 of said April Millsite, Mineral Survey No. 6685, California; thence North 0° 32' 00" West 164.74 feet to a point on the West line of said April Millsite, Mineral Survey No. 6685, California; thence South 89° 35' 30" West 327.4 feet, more or less, to Corner No. 2 of the said April #14 Mining Claim, Mineral Survey No. 6589, California, and the point of beginning. (Containing 12½ acres.)

The name of this claim is APRIL #14 MINING CLAIM, and it is a placer mining claim. It is now owned by this corporation.

This claim may be identified by its proximity to the following natural object or permanent monument, to wit: The above-given references to points of the public survey and Mineral Surveys will identify the position and location of the claim as amended.

RECEIVED  
OCT 17 2014  
USDI-BLM-CASO

RECEIVED  
OCT 9 2014  
USDI-BLM-CASO

RECEIVED  
JUN 21 2001

Exhibit C



20150002104

Attachment

VOL 82 PAGE 183  
CANS 23080

20012438

RECEIVED  
PUR. OF LAND MCHT.

~~LOCATION NOTICE  
PLACER~~

~~NOTICE IS HEREBY GIVEN:~~ That the undersigned, ~~STAUFFER CHEMICAL COMPANY~~, in compliance with the requirements of the Revised Statutes of the United States and the local laws, customs and regulations, has ~~this day located and claims the following described placer mining grounds:~~ Beginning at this monument of rock, where this notice is posted, which monument bears North 25° 23' East 382 feet from the Southwest corner of this claim; from said Southwest corner the boundaries of the claim run North 1320 feet to the Northwest corner; thence East 660 feet to the Northeast corner; thence South 1320 feet to the Southeast corner; thence West 660 feet to the said Southwest corner; together with all water and timber appurtenant, allowed by law.

This claim, consisting of 20 acres, shall be known as APRIL #22 Mining Claim. It is situated in an unknown mining district in the County of Inyo, State of California, and the locator believes that if the public surveys were extended onto the land, the area would be described as the East half of the Southwest quarter of the Northwest quarter of Section 35, Township 20 South, Range 42 East, M.D.M.

This claim may be identified by its proximity to the following natural object or permanent monument, to wit: The Northeast corner of this claim is approximately 1320 feet South of a point, which in turn is 1320 feet West of the North quarter corner of Section 35, Township 20 South, Range 42 East, M.D.M., which latter point is marked and was established by the public survey.

~~LOCATED this 29th day of May, 1959. The date of discovery and posting of this notice is the 29th day of May, 1959.~~

~~STAUFFER CHEMICAL COMPANY,~~  
a Delaware corporation, ~~Locator,~~  
By John B. Lonergan  
~~(John B. Lonergan, its Agent)~~

STATEMENT OF THE MARKING OF THE BOUNDARIES  
AND OF PERFORMANCE OF DISCOVERY WORK

~~The locator has performed discovery work as required by Sec. 2304, Public Resources Code, as follows:~~ More than 7 cubic yards of material have been excavated and removed from in place on the claim. The markings of the boundaries of the aforesaid claim as required by Sec. 2303, Public Resources Code, are designated and described as:

The discovery monument is of rock, at least 18 inches high. All corner posts are made of 4" wood, extending at least 3 ft. above ground, and are mounted in a firm rock base. Corner posts, so constructed, have been erected as corner monuments. The discovery monument is within the claim.

John B. Lonergan  
AUG 11 AM 9:23  
506 Anderson Building  
San Bernardino, California

RECEIVED  
OCT 17 2014

~~STAUFFER CHEMICAL COMPANY,~~  
a Delaware corporation, ~~Locator,~~  
By John B. Lonergan  
~~(John B. Lonergan, its Agent)~~

VOL 82 PAGE 183

WHEN RECORDED, RETURN TO  
JOHN B. LONERGAN  
506 Anderson Building  
San Bernardino, California

RECEIVED  
JUN 21 2001  
USDI-BLM-CA-SO

RECEIVED  
OCT 29 2014  
CANCELLED  
USDI-BLM-CASO

Exhibit A



20150002104

Attachment

CAMC 23068

20012438

CAMC0308 CAMC0309622

25

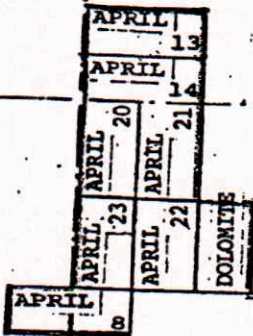
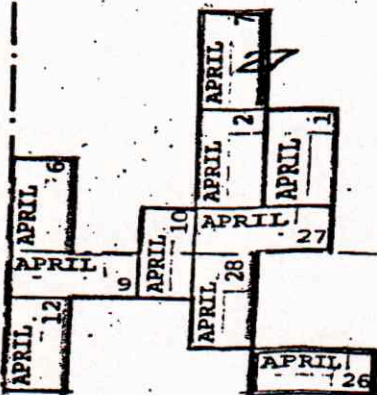

VIRGINIA 4

VIRGINIA 5

VIRGINIA 2

VIRGINIA 1

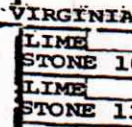
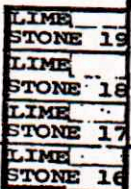

SCALE: 1 in = 2000 ft

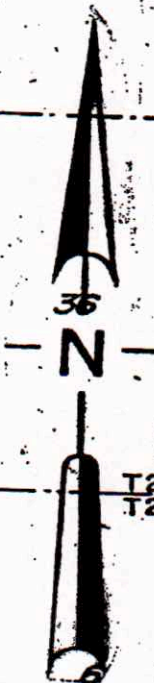

T20S  
T21S

RECEIVED  
 JUN 21 2011  
 USDI-BLM-CA-SO

APRIL ET AL GROUPS  
 KERR-McGEE CHEMICAL CORPORATION

SEC'S. 26, 27, 34 & 35 of Twp. 20 S.,  
 Rge. 42 E., SEC'S. 1 & 12 of Twp. 21 S.  
 Rge. 42 E., SEC'S. 7 & 18 of  
 Twp. 21 S., Rge. 43 E., M.D.M.  
 INYO COUNTY, CALIFORNIA

RECEIVED  
 OCT 17 2014  
 USDI-BLM-CASO

RECEIVED  
 OCT 18 2014  
 USDI-BLM-CASO

Exhibit B

R42E  
R43E