

CAMCO309627

RECORDING REQUESTED BY:  
(Mail recording to:)

Name

ACE Cogeneration Company

Address

P.O. Box 66

Trona, CA 93592



INYO, County Recorder

KAMMI FOOTE Co Recorder Office

DOC- 2015-0002109-00

Check Number 10901

Wednesday, AUG 12, 2015 10:01:45

MIC \$1.00:S21 \$3.00:REC \$14.00

SYS \$4.00:SST \$1.00:

Ttl Pd \$23.00

Rcpt # 0000110635

LS1/R1/1-4

FOR RECORDER'S USE

PLACER MINING CLAIM LOCATION NOTICE (CALIFORNIA)

To whom it may concern, please take notice that:

- 1. Placer mining claim name is Limestone
- 2. Date of location (date the proper location monument was erected and location notice posted in or on it) of this placer mining claim is 9 25 2014  
(month) (day) (year)
- 3. Description of the discovery monument is as follows: See attachments

4. Placer mining claim IS IN an area where there is a U.S. Public Land Survey and the description of the claim by legal subdivision including aliquot part (A.P.) of section (such as E1/2NE1/4NE1/4), Section (Sec.), Township (T.), Range (R.) and Meridian (Mer.), is as follows:

A.P. E 1/2 NW 1/4 SW 1/4, Sec. 18, T. 21S, R. 43E, Mer. MDM  
 A.P. \_\_\_\_\_, Sec. \_\_\_\_\_, T. \_\_\_\_\_, R. \_\_\_\_\_, Mer. \_\_\_\_\_  
 A.P. \_\_\_\_\_, Sec. \_\_\_\_\_, T. \_\_\_\_\_, R. \_\_\_\_\_, Mer. \_\_\_\_\_  
 A.P. \_\_\_\_\_, Sec. \_\_\_\_\_, T. \_\_\_\_\_, R. \_\_\_\_\_, Mer. \_\_\_\_\_

5. Placer mining claim IS NOT IN an area where there is a U.S. Public Land Survey, is marked by conspicuous and substantial monument at each claim corner, and is located by properly marked boundaries described below in reference to some natural object:

Natural object is (description) \_\_\_\_\_, and it is by compass direction \_\_\_\_\_, about \_\_\_\_\_ feet to the discovery monument. From the discovery monument it is by compass direction \_\_\_\_\_, about \_\_\_\_\_ feet to the NW corner post; from here it is by compass direction \_\_\_\_\_, about \_\_\_\_\_ feet to the NE corner post; from here it is by compass direction \_\_\_\_\_, about \_\_\_\_\_ feet to the SE corner post; from here it is by compass direction \_\_\_\_\_, about \_\_\_\_\_ feet to the SW corner post; from here it is by compass direction \_\_\_\_\_, about \_\_\_\_\_ feet to the NW corner post.

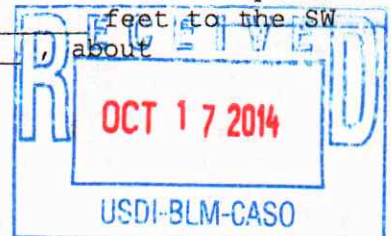

20150002109

CAMC0309627

6A. The undersigned locator(s) have defined the boundaries of the claim by erecting at each corner of the claim, or nearest accessible points thereto, a proper monument and each corner monument so erected bears or contains markings sufficient to appropriately designate the corner of the claim and the name of the claim.

6B. The date of monument erection and marking is 9 25 2014.  
(month) (day) (year)

6C. Description of each monument is as follow See attachments

7. Attach to this Notice an appropriate U.S. Geologic Survey topographic map showing a sketch of the outline of the placer mining claim.

8. Placer mining claim is in Inyo County.

9. Placer mining claim contain(s) 20 acres.

10. If your placer mining claim is in a power site withdrawal as determined from BLM Master Title Plat records, write "Filed under P.L. 359" on this line

11. Locator(s) of this placer claim are: (Please Print)

Name(s)	Current Mailing or Residence Address
ACE Cogeneration Company	P.O. Box 66 Trona, CA 93592

12. Signatures of locator(s):

Steven DeLemmon Date 10/15/14

as agent for:  
ACE Cogeneration Company Date \_\_\_\_\_

\_\_\_\_\_  
Date \_\_\_\_\_

\_\_\_\_\_  
Date \_\_\_\_\_



FILE THIS ORIGINAL NOTICE WITH THE APPROPRIATE COUNTY RECORDER (within 90 days of the date of location), AND FILE A DUPLICATE NOTICE (within the same 90 days) with the Bureau of Land Management, California State Office, 2800 Cottage Way Rm W1623, Sacramento, California 95825.

Notice of Location

Placer Claim

(See Sections 2301 - 2324, Inclusive, Public Resources Code)

RECEIVED  
OCT 10 2014

MAR 16 10 00 AM '79

SANTA ANA, CALIFORNIA

TO WHOM IT MAY CONCERN: Please take notice that:

(1) The name of this claim is LIMESTONE

(2) The name of the locator of said claim is Thomas J. Dunne

Said locator is a citizen of the United States of America or has - have declared his - their intention to become such.

(3) The said locator does hereby claim and locate a placer mining claim situate on public surveyed land in the Unknown Mining District, County of Inyo, State of California, described as follows:

(a) The East 1/2 of the N.W. 1/4 of the S.W. 1/4 Section 18, in Township 21.S, Range 43.E M.D.M., Meridian, containing 20 acres.

(b) Beginning at a located by legal subdivision (tree, rock in place, stone, post or monument)

upon which is posted the notice of location, thence (direction) \_\_\_\_\_ feet to a post marked \_\_\_\_\_ thence (direction) \_\_\_\_\_ feet to a post marked \_\_\_\_\_ thence (direction) \_\_\_\_\_ feet to a post marked \_\_\_\_\_ thence (direction) \_\_\_\_\_ feet to place of beginning. Said placer mining claim contains \_\_\_\_\_ acres.

All of said posts are at least four inches in diameter, are set at least one foot in the ground and are surrounded by a mound of stone.

This location is situated about \_\_\_\_\_ feet distant from \_\_\_\_\_ (name some natural object or permanent monument)

(4) The date of this location is the 2nd day of April

(5) This notice is intended as an original notice of location and is posted on this claim and a true copy thereof is to be recorded with the County Recorder of this County.

DATED: April 2 19 55

WITNESSES: James V. Wiseman Thomas J. Dunne

H. D. Hellmers

RECEIVED  
OCT 19 2014  
CANCELED  
UCDI BLM CASO

RECEIVED  
DEC 16 2013  
UCDI-BLM-CASO

RECEIVED  
OCT 17 2014  
UCDI BLM CASO

RECEIVED  
JUN 21 2001  
UCDI-BLM-CASO

Footnotes 1, 2, 3 and 4: See Reverse Side.

20150002109

Attach  
CAMC 3068

20012408

CAMC 308086

CAMC 309627

25

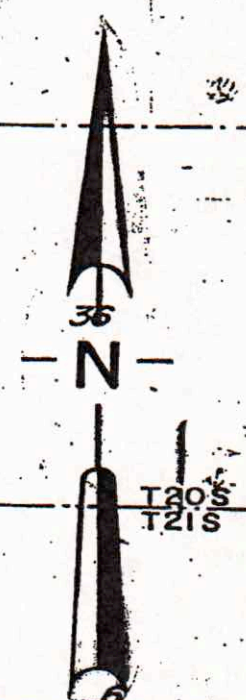
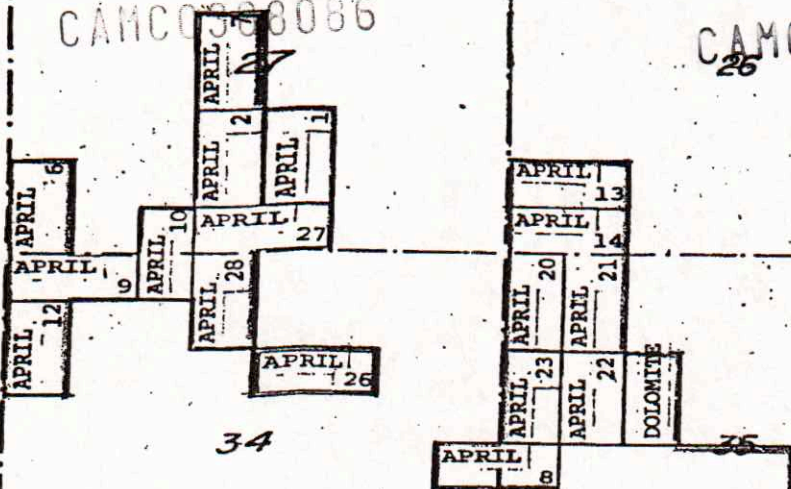

VIRGINIA 4

VIRGINIA 5

VIRGINIA 2

VIRGINIA 1

RECEIVED  
JUN 21 2001  
USDI-BLM-CA-SO

RECEIVED  
DEC 16 2013  
USDI-BLM-CASO

RECEIVED  
OCT 17 2014  
USDI-BLM-CASO

~~APRIL ET AL GROUPS~~  
~~KERR MCGEE CHEMICAL CORPORATION~~

SEC'S. 26, 27, 34 & 35 of Twp. 20 S  
Rge. 42 E., SEC'S. 1 & 12 of Twp. 21 S  
Rge. 42 E., SEC'S. 7 & 18 of  
Twp. 21 S., Rge. 43 E., M.D.M.  
INYO COUNTY, CALIFORNIA

RECEIVED  
OCT 17 2014  
USDI-BLM-CASO

VIRGINIA  
LIME STONE 19  
LIME STONE 18  
LIME STONE 17  
LIME STONE 16  
LIME STONE 15  
LIME STONE 14  
LIME STONE 13  
LIME STONE 12  
LIME STONE 11  
LIME STONE 10  
LIME STONE 9  
LIME STONE 8  
LIME STONE 7  
LIME STONE 6  
LIME STONE 5  
LIME STONE 4  
LIME STONE 3  
LIME STONE 2  
LIME STONE 1  
R42E  
R43E

Exhibit B