



CAMCO309634



INYO, County Recorder
 KAMMI FOOTE Co Recorder Office
DOC- 2015-0002116-00
 Check Number 10901
 Wednesday, AUG 12, 2015 10:04:35
 MIC \$1.00:S21 \$3.00:REC \$14.00
 SYS \$4.00:SST \$1.00:
 Ttl Pd \$23.00 Rcpt # 0000110649
 LS1/R1/1-4

RECORDING REQUESTED BY:
 (Mail recording to:)

Name
 ACE Cogeneration Company
 Address
 P.O. Box 66
 Trona, CA 93592

FOR RECORDER'S USE

PLACER MINING CLAIM LOCATION NOTICE (CALIFORNIA)

To whom it may concern, please take notice that:

- Placer mining claim name is Limestone # 13
- Date of location (date the proper location monument was erected and location notice posted in or on it) of this placer mining claim is 9 25 2014
(month) (day) (year)
- Description of the discovery monument is as follows: See attachments

4. Placer mining claim IS IN an area where there is a U.S. Public Land Survey and the description of the claim by legal subdivision including aliquot part (A.P.) of section (such as E1/2NE1/4NE1/4), Section (Sec.), Township (T.), Range (R.) and Meridian (Mer.), is as follows:

A.P. S1/2 NW1/4 NW1/4, Sec. 18, T. 21S, R. 43E, Mer. MDM
 A.P. _____, Sec. _____, T. _____, R. _____, Mer. _____
 A.P. _____, Sec. _____, T. _____, R. _____, Mer. _____
 A.P. _____, Sec. _____, T. _____, R. _____, Mer. _____

5. Placer mining claim IS NOT IN an area where there is a U.S. Public Land Survey, is marked by conspicuous and substantial monument at each claim corner, and is located by properly marked boundaries described below in reference to some natural object:

Natural object is (description) _____, and it is by compass direction _____, about _____ feet to the discovery monument. From the discovery monument it is by compass direction _____, about _____ feet to the NW corner post; from here it is by compass direction _____, about _____ feet to the NE corner post; from here it is by compass direction _____, about _____ feet to the SE corner post; from here it is by compass direction _____, about _____ feet to the SW corner post; from here it is by compass direction _____, about _____ feet to the NW corner post.



6A. The undersigned locator(s) have defined the boundaries of the claim by erecting at each corner of the claim, or nearest accessible points thereto, a proper monument and each corner monument so erected bears or contains markings sufficient to appropriately designate the corner of the claim and the name of the claim.

6B. The date of monument erection and marking is 9 25 2014.
(month) (day) (year)

6C. Description of each monument is as follow See attachments

7. Attach to this Notice an appropriate U.S. Geologic Survey topographic map showing a sketch of the outline of the placer mining claim.

8. Placer mining claim is in Inyo County.

9. Placer mining claim contain(s) 20 acres.

10. If your placer mining claim is in a power site withdrawal as determined from BLM Master Title Plat records, write "Filed under P.L. 359" on this line

11. Locator(s) of this placer claim are: (Please Print)

Name(s)	Current Mailing or Residence Address
ACE Cogeneration Company	P.O. Box 66 Trona, CA 93592

12. Signatures of locator(s):

Stevan Solomon Date 10/15/14

as agent for:

ACE Cogeneration Company Date _____

Date _____

Date _____

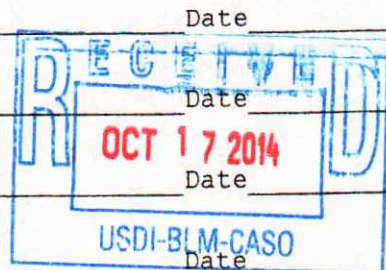

20150002116

Attach
CAMC-23068

20012413

CAMCO 308091

CAMCO 309634

25

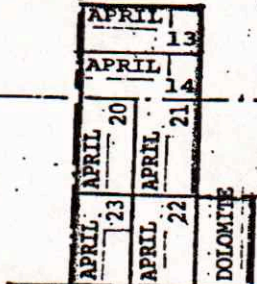
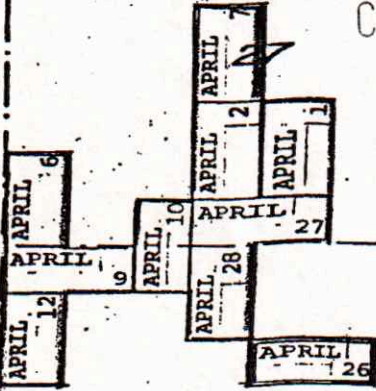

34

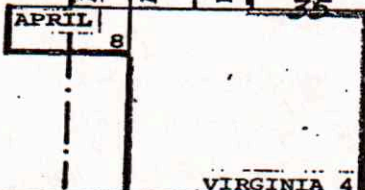

VIRGINIA 4

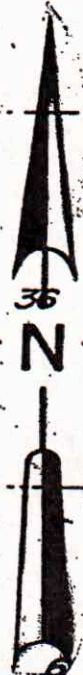

T20S
T21S

SCALE: 1 in = 2000 ft

2

VIRGINIA 5

VIRGINIA 2

11

12

VIRGINIA 1

RECEIVED
OCT 17 2014
USDI-BLM-CASO

LIME STONE 19
LIME STONE 18
LIME STONE 17
LIME STONE 16
LIME STONE 15
LIME STONE 14

VIRGINIA

LIME STONE 10
LIME STONE 9
LIME STONE 8
LIME STONE 3
LIME STONE 2

RECEIVED
DEC 16 2013
USDI-BLM-CASO

RECEIVED
OCT 9 2014
18
USDI-BLM-CASO

APRIL ET AL GROUPS
KERR-McGEE CHEMICAL CORPORATION

SEC'S. 26, 27, 34 & 35 of Twp. 20 S.,
Rge. 42 E., SEC'S. 1 & 12 of Twp. 21 S
Rge. 42 E., SEC'S. 7 & 18 of
Twp. 21 S., Rge. 43 E., M.D.M.
INYO COUNTY, CALIFORNIA

RECEIVED
JUN 21 2001

R42E
R43E

Exhibit B

USDI-BLM-CASO

Attached

CAMCO3091

Notice of Location

Placer Claim

(See Sections 2301-2324, Inclusive, Public Resources Code)

RECEIVED
DIV. OF LAND MGMT.

MAR 16 10 00 AM '77

SACRAMENTO CALIF 20012413

CAMCO308091

TO WHOM IT MAY CONCERN: Please take notice that:

- (1) The name of this claim is LIMESTONE AL 300309634
- (2) The name of the locator of said claim is James V. Wiseman
(is - are)

Said locator is a citizen of the United States of America or declared
(is a - are) (has - have) (his - their)

~~intends to become such.~~
(8) The said locator does hereby claim and locate a placer mining claim situate on public surveyed land in the Unknown Mining District

County of Inyo, State of California, described as follows:

(a) The South 1/2 of the N.W. 1/4 Section 18 of the N.W. 1/4 Section 18, in Township 21.8, Range 43.E., M.D.M. Meridian, containing 20 acres.

(b) Beginning at a located by legal subdivision
(tree, rock in place, stone, post or monument)

_____ upon which is posted the notice of location, thence
(direction) _____ feet to a post marked _____, thence
(direction) _____ feet to a post marked _____, thence
(direction) _____ feet to a post marked _____, thence
(direction) _____ feet to place of beginning. Said placer mining claim contains _____ acres.

All of said posts are at least four inches in diameter, are set at least one foot in the ground and are surrounded by a mound of stone.

This location is situated about _____ feet distant from _____
(name some natural object or permanent monument)

(4) The date of this location is the 6th day of April, 19 55

(5) This notice is intended as an original notice of location and is posted on this claim and a true copy thereof is to be recorded with the County Recorder of this County.

DATED: April 6, 19 55

WITNESSES: [Signature] LOCATORS: James V. Wiseman
[Signature] James V. Wiseman

RECEIVED
OCT 17 2014
USDI-BLM-CASO

RECEIVED
OCT 18 2014
USDI-BLM-CASO

RECEIVED
DEC 16 2013
USDI-BLM-CASO

JUN 21 2001

Footnotes 1, 2, 3 and 4, See Reverse Side.

Exhibit A