



COUNTY OF INYO

DEPARTMENT OF PUBLIC WORKS
P.O. DRAWER Q
INDEPENDENCE, CA 93526

REQUEST FOR QUOTATION ***THIS IS NOT AN ORDER***

DATE ISSUED: 04/09/2019

Michael Errante, Director, Public Works
Chris Cash, Deputy Director - Operations, Public Works
(760) 878-0201 Front Desk
(760) 878-2001 Fax

RETURN BY: 04/23/2019

Email back to Jamie Sidhu at csidhu@inyocounty.us
PLEASE QUOTE ON THE FOLLOWING ITEMS: **Laws Railroad Museum**
102 Main St, Laws, CA

QUANTITY	DESCRIPTION	TOTAL PRICE
	<ul style="list-style-type: none"> Install one 4" Backflow prevention assembly, one 4" water meter and one 4" curb stop valve on a 4" water line. The devices must be installed in a way that would provide easy access for future testing and repair. All local and state guidelines regarding installation of backflow prevention assemblies, water meters and curb stop valves must be followed. Perform any digging or trenching work required for the installation of these devices. The devices will be provided by the County. After installation, the backflow prevention assembly must be tested by a certified backflow prevention tester and a test report must be submitted to the County. 	
	<ul style="list-style-type: none"> Install one Mueller "A-423" 5-1/4" fire hydrant as per Inyo County Standard Details –Drawing No. W-124 (6" x 4" x 2.5" STANDARD FIRE HYDRANT) and manufacturer's specifications. The fire hydrant will be provided by the County. After final installation is complete, exercise and flush Hydrant to ensure proper operation. 	
	<ul style="list-style-type: none"> Install a 320 ft. long 6" PVC pipe as per manufacturer's specifications. Also install two shut-off valves near each end of the pipe as shown in plans. The trenching for the pipe will be provided by the County. PVC pipe as well as the shut-off valves will be provided by the County. The pipe shall have a No. 10 gauge solid soft drawn copper locator wire taped on top of the pipe to facilitate locating the pipe at a later date. The wire shall be stubbed up inside each valve box. Continuity test shall be conducted on each splice at all locations. A strand of 3" wide non-detectable blue tape marked "Water" shall be placed 12 inches above all piping. 	
	<ul style="list-style-type: none"> This is a prevailing wage job. Bidder must have either a Class A license or a combination of licenses required to complete this job. Installation to be completed no later than 45 days after award. 	
	PRICE TO INSTALL SHALL INCLUDE ALL COSTS INCLUDING LABOR, MATERIALS, INSURANCE, AND APPLICABLE TAXES.	
		TOTAL
	INDICATE ANY EXCEPTIONS TO QUOTE:	
	This form to be returned signed, via e-mail by 3:30 PM at 04/18/2019	

To schedule a pre-bid **job walk** (recommended), please contact Chris Cox at (760) 878-0230.

THE QUOTATION (S) LISTED ABOVE REMAIN VALID AND IN EFFECT THROUGH _____.

DATE: _____ By _____
(Print)

FIRM NAME _____ By _____
(Signature) (Title)

>> RETURN SIGNED FORM TO THE INYO COUNTY PUBLIC WORKS DEPT, Via Email to csidhu@inyocounty.us or fax (760)-878-2001

BURY 2" (0.61m) MIN.
LONGER BY 6"
(152mm) INTERVALS

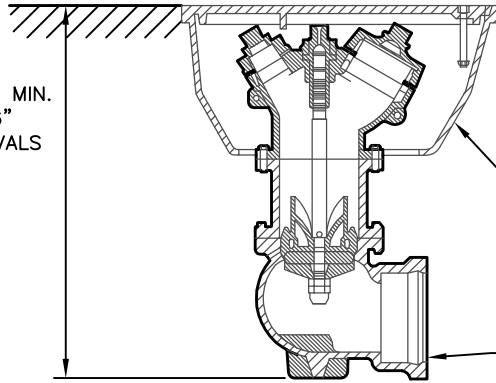

TRAFFIC LID TO
BE INCLUDED IN
INSTALLATION

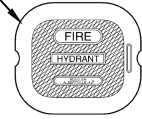

FURNISH AND INSTALL TRAFFIC
RATED FLUSH TYPE DRY BARREL
FIRE HYDRANT (MUELLER 1-415)
TYPE "B" HYDRANT

CONNECTION TO WATER MAIN TO BE
THE SAME AS TYPE "A" HYDRANT

FLUSH MOUNT HYDRANT

ELEVATION VIEW

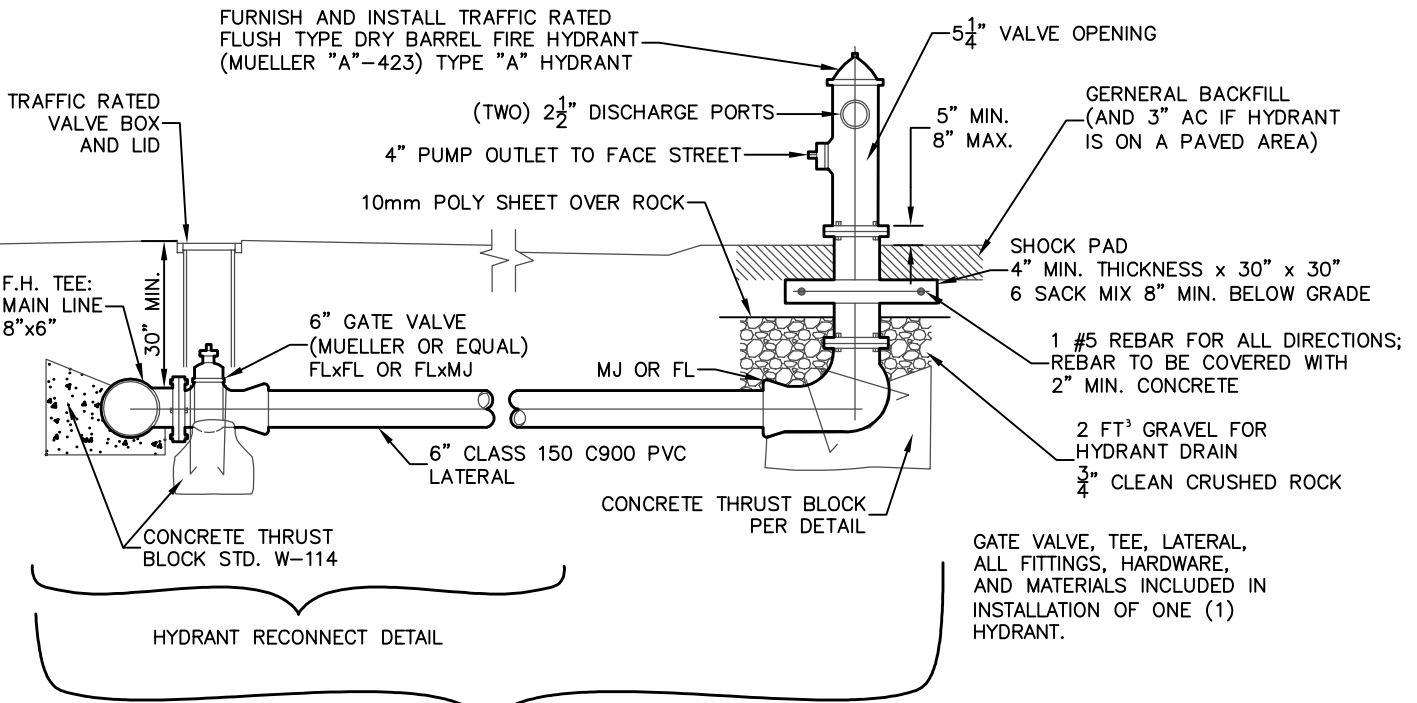

FURNISH AND INSTALL TRAFFIC RATED
FLUSH TYPE DRY BARREL FIRE HYDRANT
(MUELLER "A"-423) TYPE "A" HYDRANT

TRAFFIC RATED
VALVE BOX
AND LID

(TWO) 2 1/2" DISCHARGE PORTS

4" PUMP OUTLET TO FACE STREET

10mm POLY SHEET OVER ROCK

F.H. TEE:
MAIN LINE
8"x6"

30" MIN.

6" GATE VALVE
(MUELLER OR EQUAL)
FLxFL OR FLxMJ

MJ OR FL

6" CLASS 150 C900 PVC
LATERAL

CONCRETE THRUST
BLOCK STD. W-114

HYDRANT RECONNECT DETAIL

NEW HYDRANT INSTALL DETAIL

5 1/4" VALVE OPENING

5" MIN.
8" MAX.

GENERAL BACKFILL
(AND 3" AC IF HYDRANT
IS ON A PAVED AREA)

SHOCK PAD

4" MIN. THICKNESS x 30" x 30"
6 SACK MIX 8" MIN. BELOW GRADE

1 #5 REBAR FOR ALL DIRECTIONS;
REBAR TO BE COVERED WITH
2" MIN. CONCRETE

2 FT³ GRAVEL FOR
HYDRANT DRAIN
3/4" CLEAN CRUSHED ROCK

CONCRETE THRUST BLOCK
PER DETAIL

GATE VALVE, TEE, LATERAL,
ALL FITTINGS, HARDWARE,
AND MATERIALS INCLUDED IN
INSTALLATION OF ONE (1)
HYDRANT.

6"x4"x2.5" STANDARD FIRE HYDRANT

ELEVATION VIEW

INYO COUNTY PUBLIC WORKS DEPT.

DATE: SEPT 2015

DRAWN BY: TD

APPROVED BY: JA

Clint Quilter
CLINT QUILTER - Director

NEW FIRE HYDRANT
INSTALLATION DETAILS

W-124

LAWS MUSEUM PROJECT – PLANS

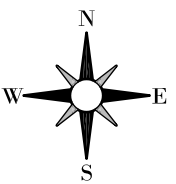
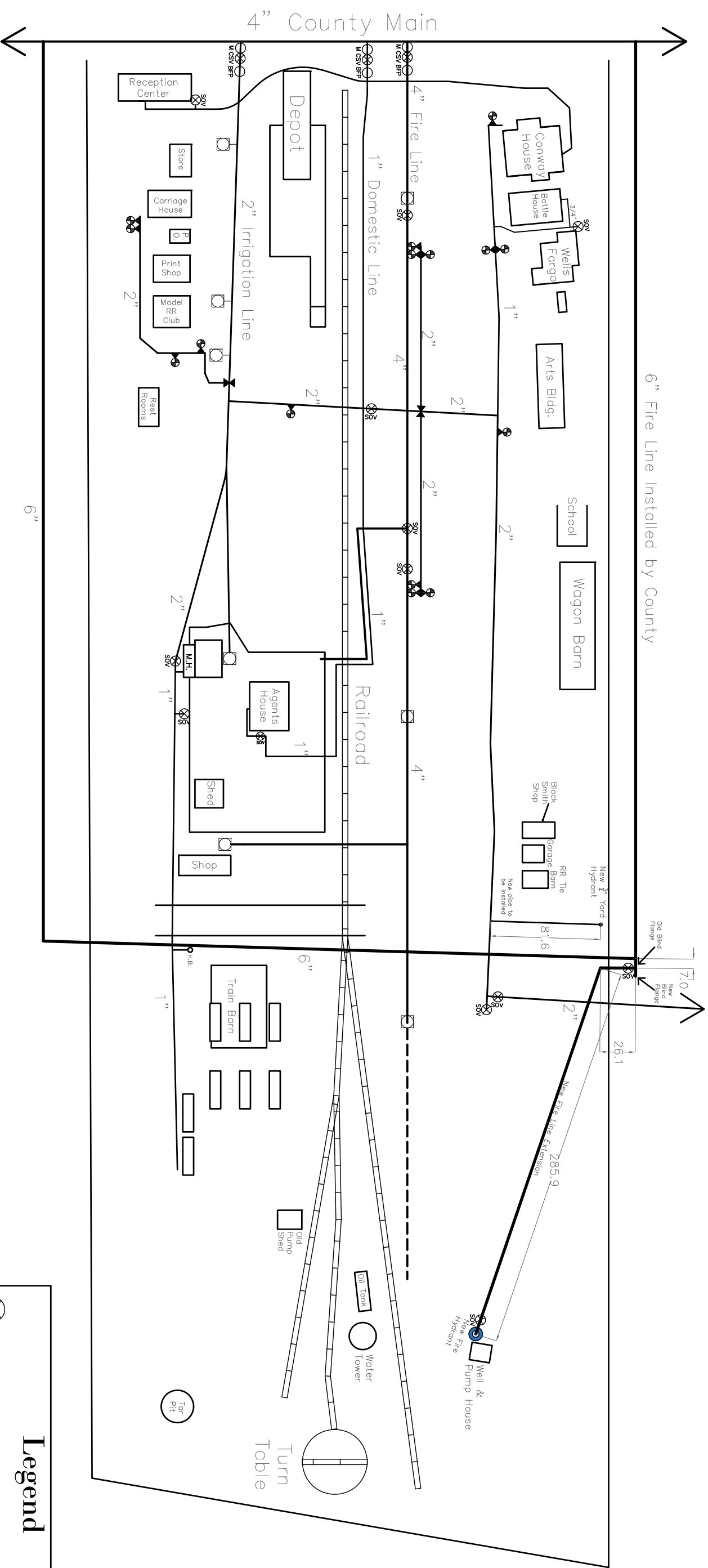

Legend	
	Curb stove Valve
	Shut-Off Valve
	Backflow Preventer
	Water Meter